

Internal Lift

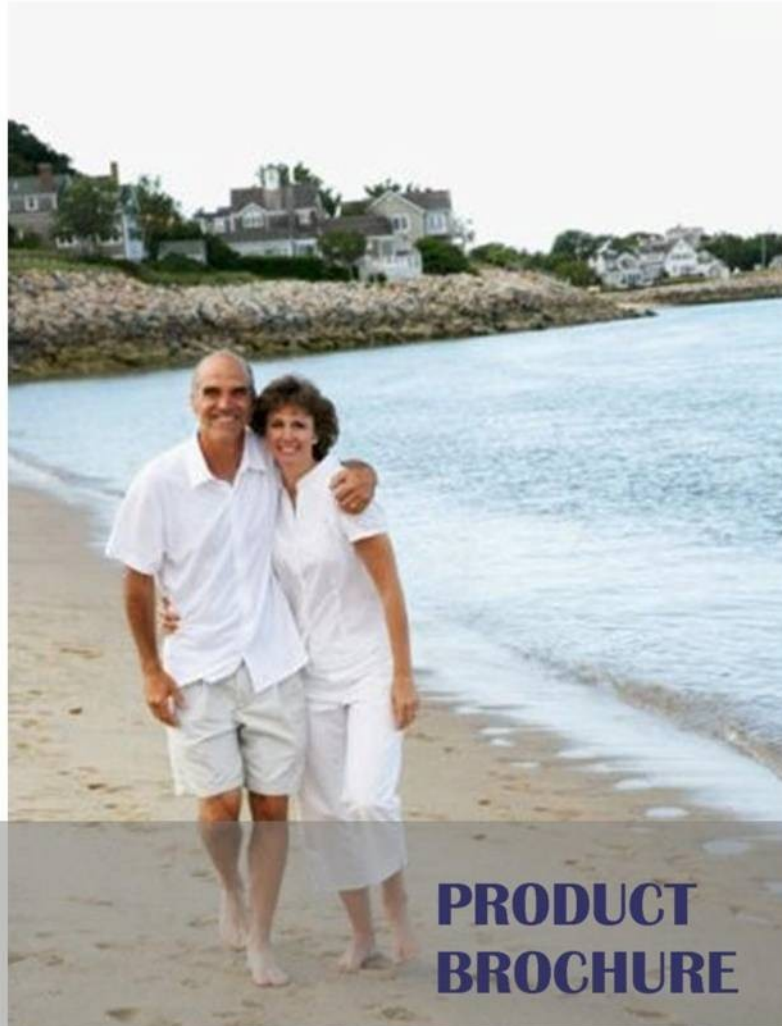

SUPPLIED BY
Personal
HOME ELEVATORS
ESTABLISHED - MARYBOROUGH 1985
1800 818 406



**PRODUCT
BROCHURE**

Helping you to do the things you enjoy !

Frequently Asked Questions

- Q. - Can an RGH lift be parked at the upper level?**
A. - Yes, our lifts are engineered as per section 11 of the Australian Standard and are available for immediate use. This is an important feature to quickly exit the home in case of an emergency.

Some companies auto return their lifts to the ground level after each use. This will be inconvenient, increase your electricity bill and may also increase your service costs.

- Q. - Is it safe to open an RGH control cabinet?**
A. - Yes, our electronic control enclosure only has extra low voltage present (below 24 Volt). There is no 240 VAC equipment.

- Q. - Is the RGH water pump located in the control cabinet?**
A. - No, we do not install electronic equipment in an environment which could be affected by the hazards of moisture and water.

- Q. - Where is the RGH water recirculation pump located?**
A. - It is a stand alone unit mounted externally beside the lift tower or remotely fitted outside of the home connected to it's own weatherproof GPO.

- Q. - How do you stop your liftcar when it reaches the upper level?**
A. - We use positive acting limit switches, an electronic and manual valve system combined to de-accelerate the car for unparalleled operation and reliability!

- Q. - Can you supply a custom size lift?**
A. - Yes, RGH specialises in designing to customers needs and this is supported by certified engineering.

- Q. - Should I purchase a lift now or can I wait?**
A. - The decision is yours, but from experience, having the comfort and the convenience of owning a lift now, appears to give people peace of mind knowing they have independence for the unforeseen and have saved money by purchasing now.



RGH

PERSONAL HOME ELEVATORS

POSTAL PO Box 4098, FACTORY: 184 NERADA RD, TINANA QLD 4650.
Phone 1800 818 406 Fax 07 41214092 Email admin@rghlifts.com.au



Internal Lift with External grade doors



Standard Single vision Panel Door
Automatic Lift with Landing Recall & Indicator features

RGH

PERSONAL HOME ELEVATORS

POSTAL PO Box 4098, FACTORY: 184 NERADA RD, TINANA QLD 4650.
Phone 1800 818 406 Fax 07 41214092 Email admin@rghlifts.com.au



E3 – 17 model / Custom Internal Lift Interiors / Custom size



RGH

PERSONAL HOME ELEVATORS

POSTAL PO Box 4098, FACTORY: 184 NERADA RD, TINANA QLD 4650.

Phone 1800 818 406 Fax 07 41214092 Email admin@rghlifts.com.au



Standard (MBF) Doors



RGH

PERSONAL HOME ELEVATORS

POSTAL PO Box 4098, FACTORY: 184 NERADA RD, TINANA QLD 4650.

Phone 1800 818 406 Fax 07 41214092 Email admin@rghlifts.com.au



Landing Controls



Car Controls



Liftcar Phone Enclosure

MODEL	"ELITE" AUTO E2A
AUSTRALIAN STANDARD COMPLIANCE	1735 PART 17
SPECIFICATIONS	
CAVITY WIDTH	1400mm
CAVITY DEPTH	1650mm
CAVITY HEIGHT	4500mm approx
CYLINDER PROTRUSION (above tower)	600mm approx
CAR WIDTH	900mm
CAR DEPTH	1450mm
CAR WALL HEIGHT	2000mm
TRAVEL RESTRICTIONS	Up to 3000mm
TRAVEL SPEED	UP TO 0.08mts/sec approx
LOAD RATING	250KG/550lbs
APPROX WATER USAGE (per cycle)	4 Gallons / 18 Litres
WATER PRESSURE REQUIRED	MIN 55PSI / 385 Kpa
SAFETY FEATURES	
DOOR & LIFT CAR SAFETY INTERLOCKING SYSTEM	INCLUDED
BATTERY BACKUP	INCLUDED
TELEPHONE MOUNTED IN LIFT CAR	INCLUDED
COMMERCIAL LIFT CAR TRAVELLING CABLE	AUSTEL APPROVED
LIFT CAR GUIDE ROLLER BACKUPS	INCLUDED
UPPER GUIDE ROLLER COVERS	INCLUDED
EMERGENCY LOWERING FACILITY	INCLUDED
DUAL AIR VENT VALVES	CYLINDER DIRECT MOUNTED
DOOR INTERIOR FINISH	FLUSH SURFACE
CARRYING CAPACITY	WHEELCHAIR & CARER
HYDRAULIC PRESSURE TESTED	PRE-DELIVERY
HOSE BURST FAILSAFE DEVICE	CYLINDER FLOW RESTRICTOR
LIFTCAR OVERLOAD PROTECTION	SYSTEM RELIEF VALVE
UPPER SERVICEMAN CLEARANCE /PIT PROP	INCLUDED WITH STOP SWITCH
LOWER SERVICEMAN CLEARANCE	PIT PROP INCLUDED
LOAD HOLDING DEVICE	CHECK VALVE SYSTEM
EMERGENCY PASSENGER RELEASE	KEY OPERATED
UPPER LEVEL ANTI CREEP	TOP FLOOR RELEVELLING SYSTEM
CAR ENTRANCE LIGHT BEAM DETECTORS	INCLUDED
STANDARD FEATURES	
ELECTRONIC CONTROLS	AUTOMATIC
MOISTURE & CORROSION PROTECTION FOR ELECTRONIC CONTROLLER	REMOTE LOCATION OF RESERVOIR & PUMPING UNIT (IF REQUIRED)
EMERGENCY TIMER LIGHT	CAR MOUNTED
CAR RECALL CONTROL SYSTEM	MOUNTED AT LANDING STATIONS
240V AC INDICATOR LED	CAR MOUNTED
CAR LANDING INDICATOR LED	MOUNTED AT LANDING STATIONS
CAR CONTROL LOCK (KEY OPERATED)	CAR MOUNTED
CAR WALL LINING	EASY CLEAN LAMINATE
COLOUR OF CAR WALLS	GREY LOWER & WHITE UPPER
CAR CEILING	DIFFUSED PANELLING
CAR FLOOR CARPET	FULL
COLOUR OF CARPET	GREY
ELECTRONIC SWITCHES	STD (WHITE) CLASSIC 2000 SWITCH PLATES
LIFT WELL	SHAFT INTERNAL LINING INCLUDED
LANDING DOOR CONSTRUCTION	PAINTABLE FINISH MDF CONSTRUCTION
LANDING DOOR VISION PANELS	1 PER DOOR
DOOR JAMS PROVIDED	PAINTABLE TIMBER
LIFT CAR FRAME	ALUMINIUM
LIFT TOWER FRAME	GAL STEEL
WARRANTY	12 MONTHS
SERVICE REQUIREMENTS	12 MONTHLY
SERVICEABLE EQUIPMENT LOCATION	WALL MOUNTED FOR EASY ACCESS

PLEASE READ

This brochure is a guide only and all care has been taken to ensure that the information is correct at the time of publication. RGH may alter details contained in this brochure at any time, therefore prior to ordering you must check that the chosen specifications and equipment are available.

ACCESSORIES, AVAILABLE @ EXTRA COST

SECURITY LOCKS
PASSENGER HANDRAIL
COLOUR (NON STANDARD)
MIRROR ON LIFT CAR WALL
WATER PRESSURE AMPLIFIER (stand alone unit)
RECIRCULATION SYSTEM (stand alone unit)
AUTOMATIC POWER DOORS
CUSTOM DOOR DESIGNS
COSMETIC FINISHING TO SUIT HOME DÉCOR'

◆ HIDDEN DOOR INTERLOCKING SENSOR

◆ NEAT LANDING FINISH WITH NO COLOURBOND DOOR SURROUNDS

◆ CUSTOM VISION PANELS



◆ STANDARD DESIGN CAR FITOUT



◆ OPTIONAL CUSTOMISED DOOR WITH EXTERNAL BOLLECTION MOULDING



◆ CUSTOM CAR FINISHING

◆ SECURITY & ACCESS TO SUIT YOUR NEEDS

◆ PROFILED STAINLESS STEEL

***BUILDERS
INFORMATION***

WORK BY PROPRIETORS BUILDER

- **240v 2 WAY SWITCHING, SHAFT MOUNTED LIGHT**
 - CENTRE MOUNTED 4 FT FLURO LIGHT RUNNING FROM FRONT TO BACK ON UNDERSIDE OF OUR TOWER ROOF ASSEMBLY. WIRING AND SWITCH PLATES TO BE MOUNTED BETWEEN TIMBER SHAFT FRAMING AND LIFT STEEL FRAMING (not in lift shaft)
- **ONE SINGLE 240v STD 10 AMP GPO FOR CONTROL BOARD SUPPLY (2 amp load)(REQUIRED FOR E2 MODEL ONLY)**
 - POWER POINT LOCATION TO BE DETERMINED BY LIFT MANUFACTURER AND BUILDER. (RECOMMENDED TO BE ON A SEPARATE CIRCUIT, BESIDE THE CONTROLLER AND WITHIN 2m OF LIFT ENTRANCE)
- **ONE SINGLE 240v STD 10 AMP GPO FOR RECIRCULATION SYSTEM (6 amp load) if required**
 - POWER POINT LOCATION TO BE DETERMINED BY LIFT MANUFACTURER AND BUILDER (IF UNIT IS REQUIRED)
- **TWO 3/4" PIPES FOR SUPPLY & EXHAUST WATER, TO BE INSTALLED IN THE FLOOR SLAB OR INTERNAL WALLS FROM OUTSIDE SUPPLY TO LIFT SHAFT LOCATION.(If Required)**
 - EXHAUST WATER TO GARDEN OUTLET OR STORM WATER (SUBJECT TO LOCAL AUTHORITY REQUIREMENTS)
 - FOR LOCATION OPTIONS REFER TO DRAWING SPECS
- **CARPENTRY TRIMMING OFF AROUND LANDING DOORS AND HEADERS**
 - UPPER AND LOWER SHAFT ENTRANCE AREAS TO BE LEFT CLEAR FROM FLOOR TO CEILING AT 1400mm WIDTH UNTIL EQUIPMENT IS INSTALLED.
- **CARPENTRY OF SHAFT (NOT LINED INTERNALLY)**
 - SUBJECT TO EQUIPMENT ACCESS, THE SHAFT CAN BE COMPLETED MINUS UPPER AND LOWER ENTRANCE AREAS.
 - ENSURE THAT OVERHEAD TRUSSES OR TIMBER FRAMING DO NOT INTERFERE WITH LIFT CAR CYLINDER HEADSTOCK TRAVEL PATH
 - UPPER FLOOR ENTRANCE FACIA TO BE LEVEL AND IN LINE WITH LOWER FLOOR ENTRANCE CONCRETE RECESS FACIA (60mm step down)
 - CHECK CEILING CLEARWAY DIMENSION FOR LIFTING CYLINDERS
- **ACCESS FOR LIFT EQUIPMENT**
 - A) COMPONENT SYSTEM - COMPONENTS FOR ACCESS ARE ONE REAR WALL (5300 x 1230 x 100mm PANEL), AND THE LIFT CAR (2100 x 1230 x 1600mm)
 - B) MODULAR SYSTEM TO BE CRANED INTO POSITION PRIOR TO TRUSS AND ROOFING PLACEMENT
- **FINISH PAINTING**
 - ARCHITRAVES, DOORS, ETC.
- **ALLOWANCE TO BE MADE FOR OPENING OF DOORS IF FLOOR TILES OR CARPET IS FITTED AFTER LIFT IS INSTALLED.**
 - MANUFACTURER TO BE SUPPLIED WITH ACCURATE MEASUREMENT FROM UPPER FINISHED FLOOR LEVEL TO LOWER FINISHED FLOOR LEVEL
- **ONSITE CONNECTION OF TELEPHONE**
 - CONNECTION OF SHAFT MOUNTED JUNCTION BOX TO PHONE LINE
 - CONNECTION OF SHAFT MOUNTED JUNCTION BOX TO CAR MOUNTED TELEPHONE

COUNCIL PERMITS, FEES AND APPROVALS**CRANE HIRE**

IF NOT ALREADY SUPPLIED, COULD YOU PLEASE SEND US A COPY OF PLAN AND ELEVATION DRAWINGS FOR DISCUSSION REFERENCE AND EQUIPMENT ACCESS.

SINGLE SIDE ENTRY LIFT

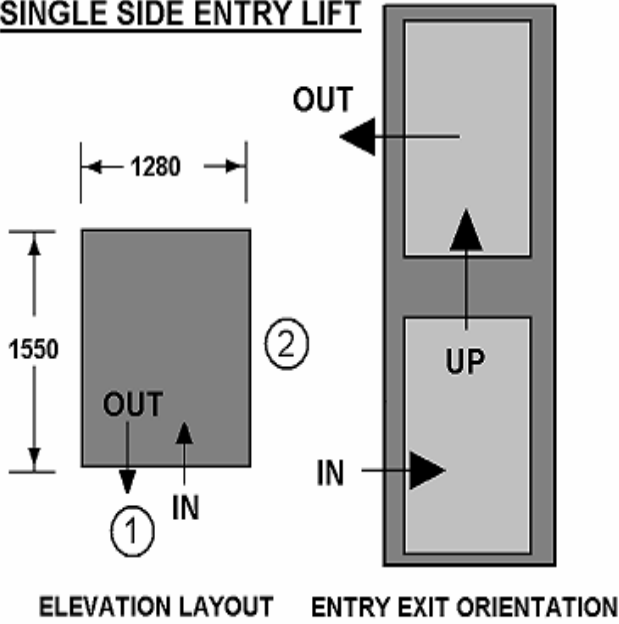

WALKTHROUGH ENTRY LIFT

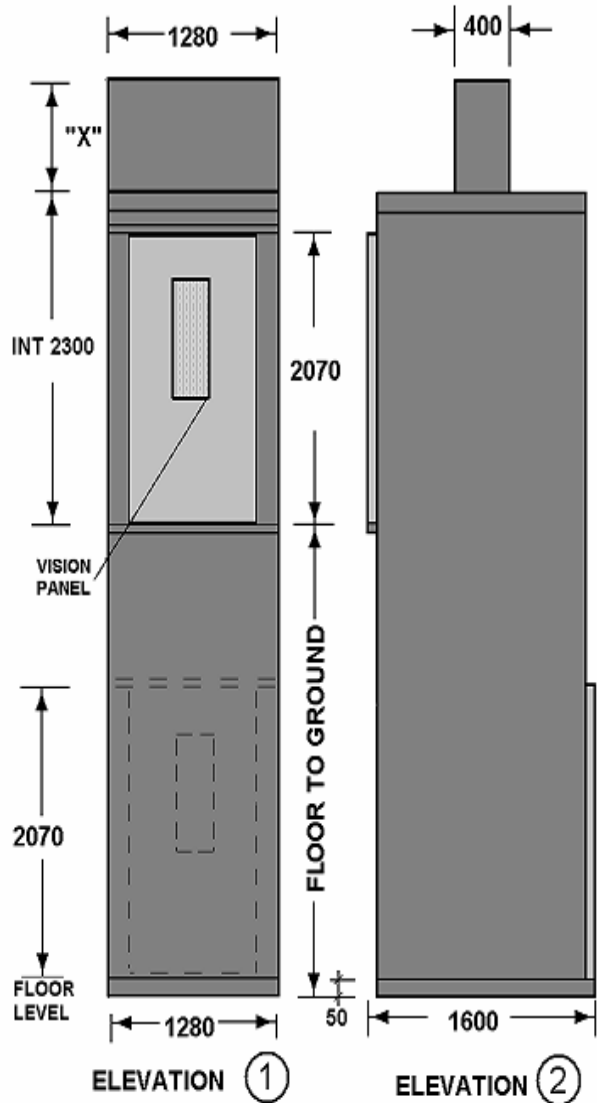
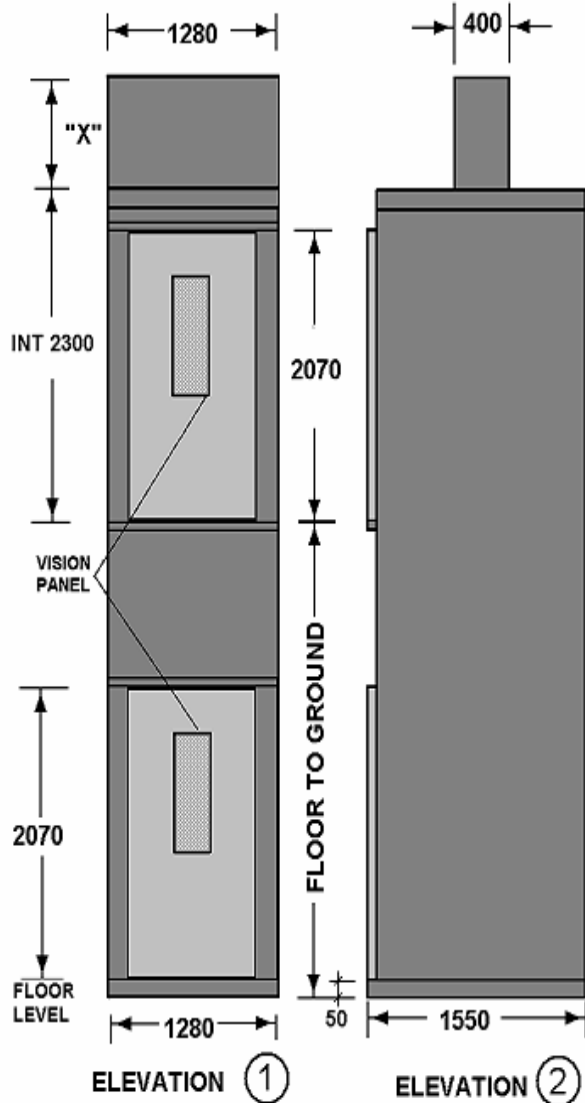
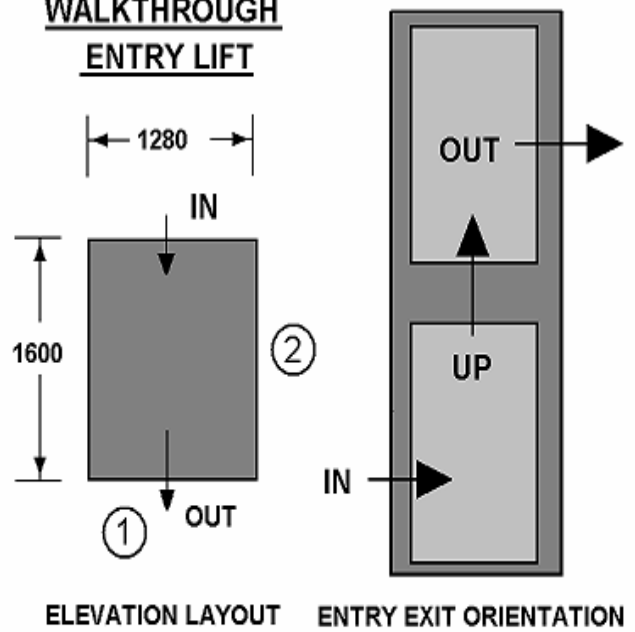

RGH GOLDEASE PTY LTD trading as
HYDRAULICS
 & HOUSEHOLD WATER LIFTS
REG ELEVATOR MANUFACTURER
 PO BOX 4098, 184 NERADA RD, TINANA QLD 4650
 PHONE: (07) 41213745 FAX: (07) 41214092

INTERNAL WATERLIFT
 TYPE # E2CP
 & E2A

DATE: 22/08/2005
 DRAWN BY R.CHERRY

INTERNAL UNIT DIMENSION "X" = FLOOR TO RECESS + 300 - 2300 (GROUND)



PERSONAL HOME ELEVATORS

Postal: PO Box 4098, TINANA QLD 4650

Phone: 07 4121 3745 Fax: 07 4121 4092 Email- admin@rghlifts.com.au

B2 & E2 INTERNAL LIFT WELL CLEARWAY THROUGH CEILING

SINGLE AND WALK THROUGH ENTRY LIFTS

STANDARD 60mm RECESS

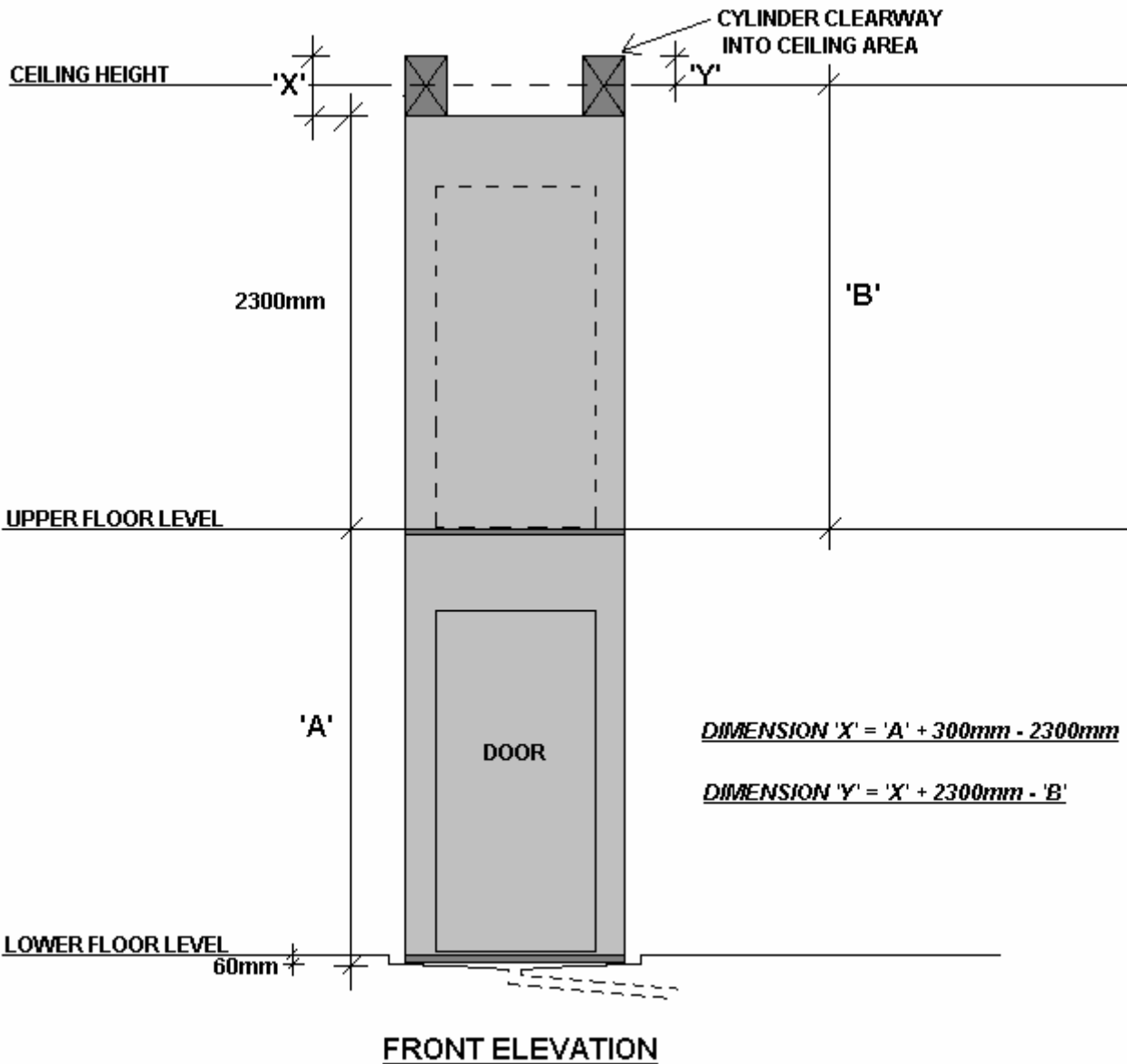
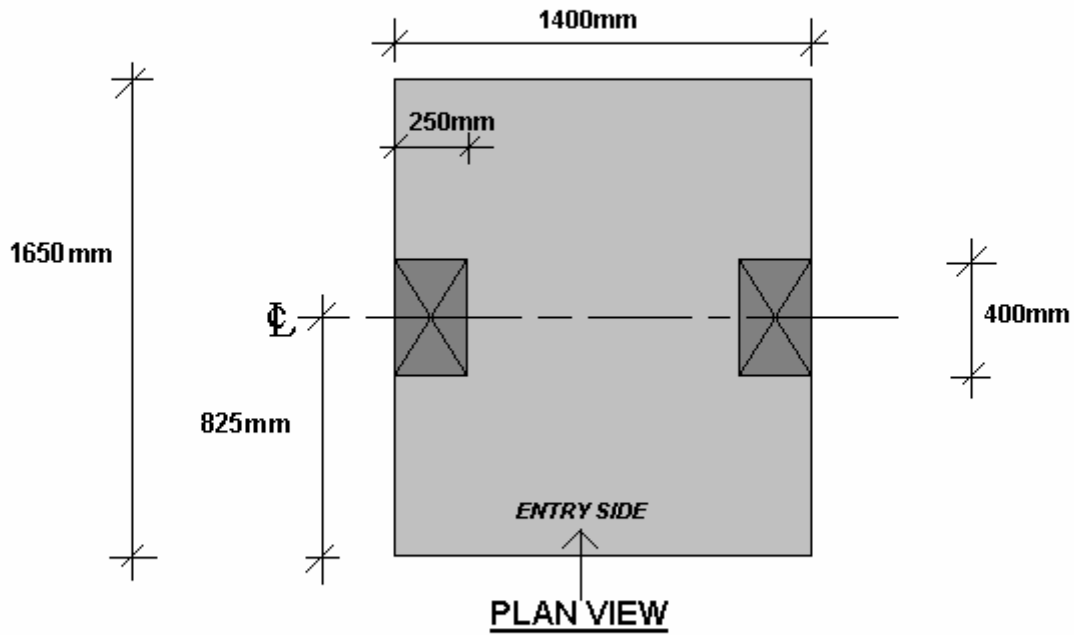

**INTERNAL B2 & E2 RECESSED CONCRETE FOUNDATION
SINGLE AND WALK THROUGH ENTRY LIFTS
STANDARD 60mm RECESS
THROUGH WALL PLUMBING**

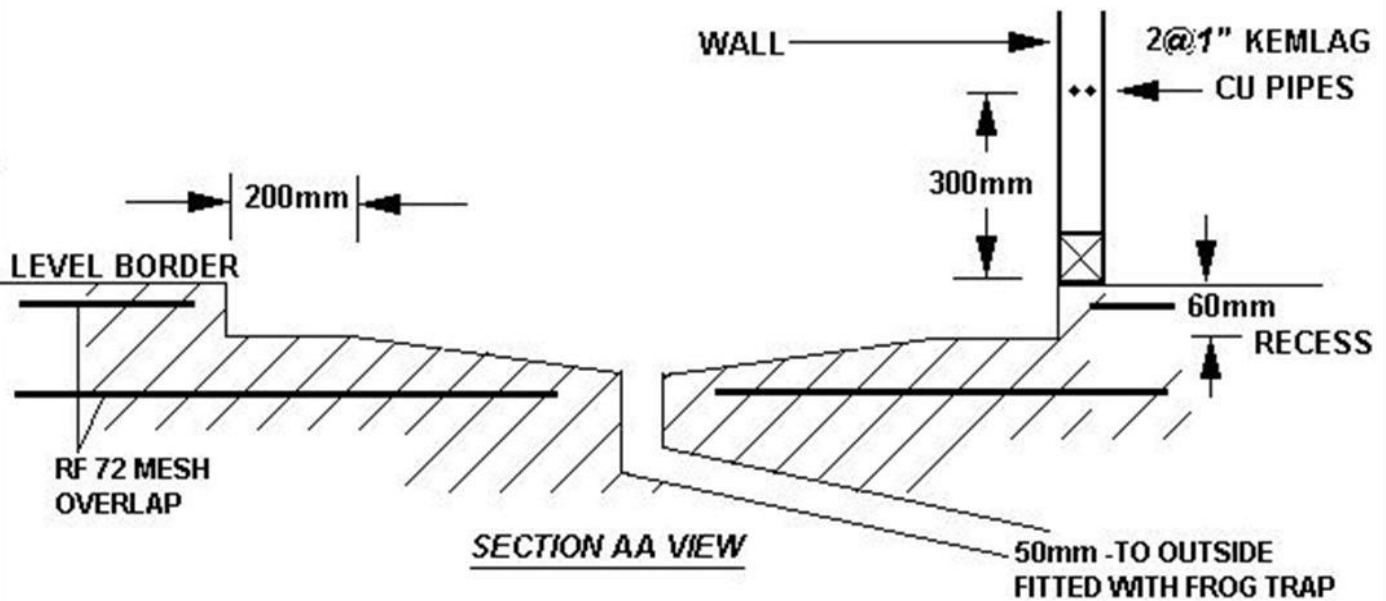
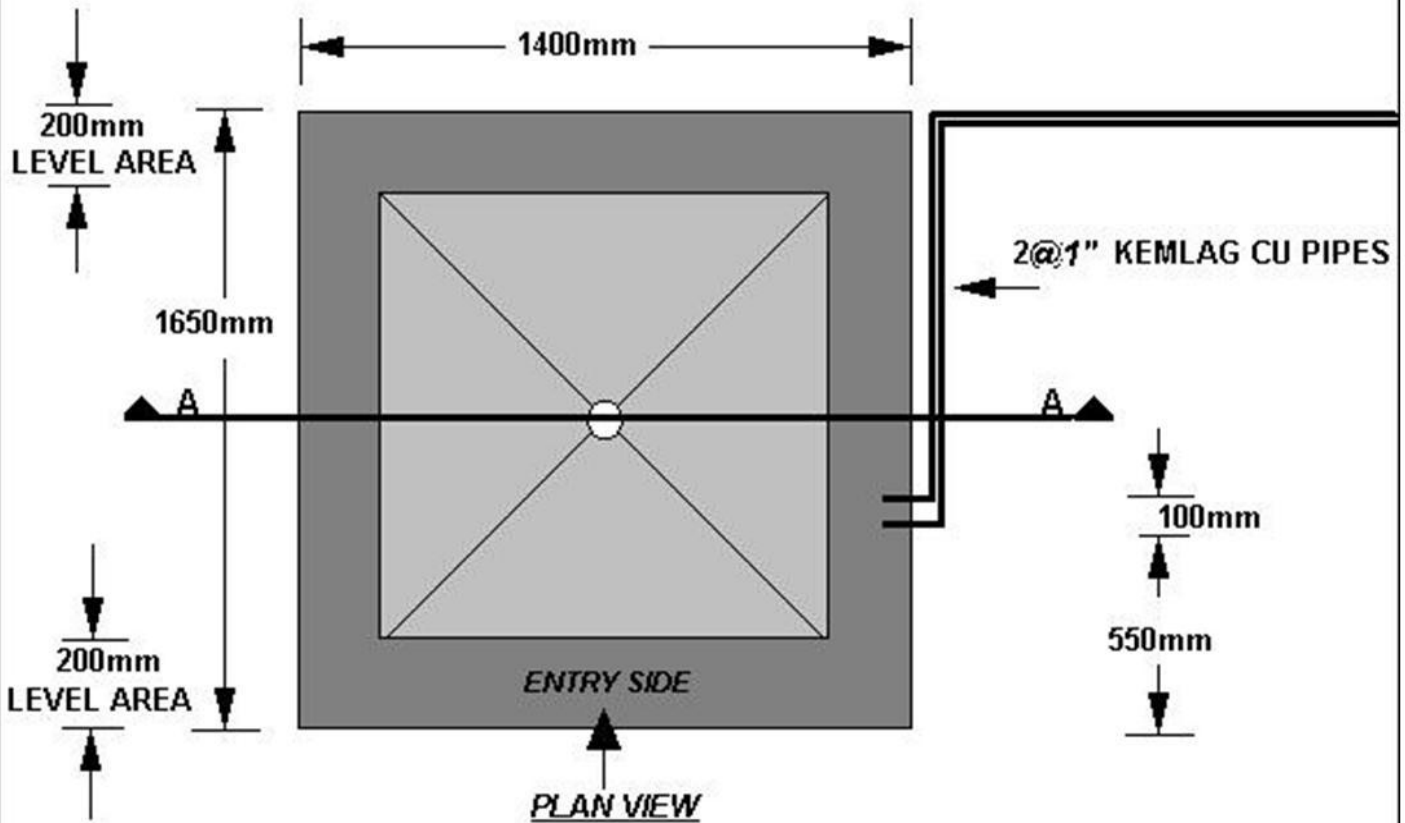

Two 1" pipes for supply & exhaust water, to be installed in the internal walls from outside supply to lift shaft location on either left or right hand side - to be advised by RGH

Floor waste drainpipe to be fitted with at least a frog trap.

"EXAMPLE ONLY"

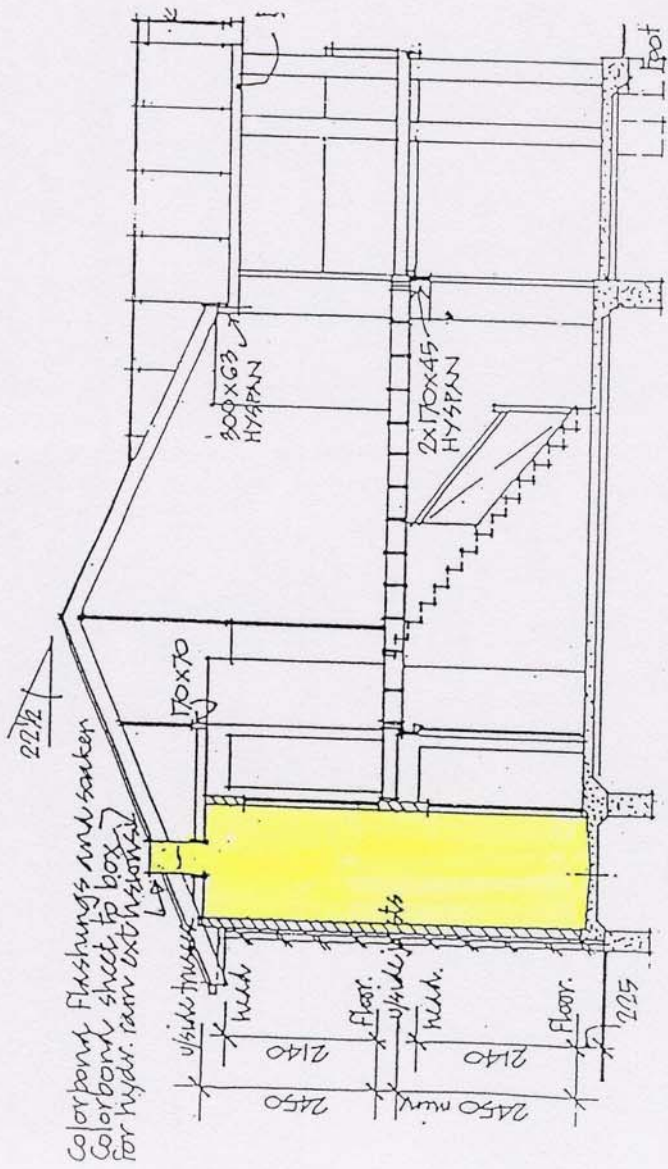

SECTION A-A.

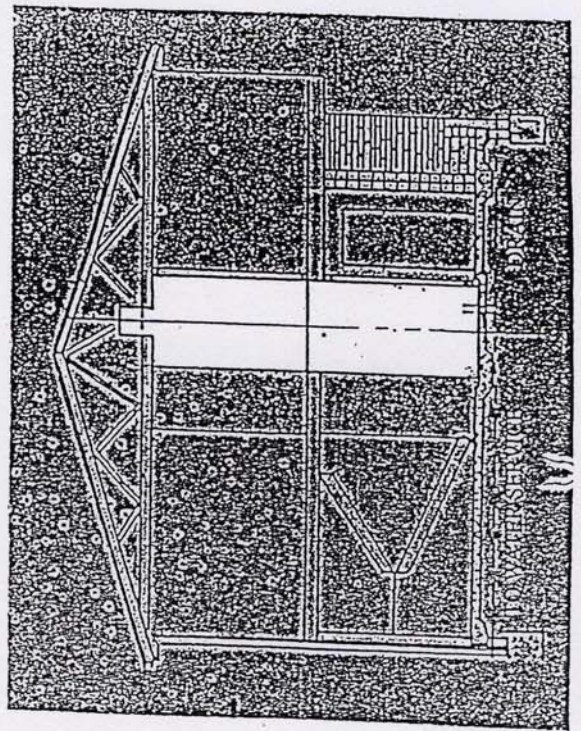

Peace of mind with engineering excellence



RGH *Personal Home Elevators*

POSTAL: P.O. Box 4098, FACTORY: 184 Nerada Rd, TINANA QLD 4650
PHONE: 1800 818 406 FAX: 07 4121 4092 EMAIL: admin@rghlifts.com.au
WEBSITE: www.rghlifts.com.au